

MANUAL EQUIPMENT

AUTOMATIC EQUIPMENT

VISION

MARKING

AUTOMATED SOLUTIONS

COMPONENT PROCESSING



This 8-head, Pick and Place automatic taping machine has earned the reputation of being the most versatile of the V-TEK line. The **TM-8000** design is centered on flexibility and value added processes such as vision inspection, testing, sorting, and part marking. The simple design also incorporates the ability to rotate devices in the nozzle between each station in the process.

Features :

- Eight position Pick & Place heads for processing bowl or tube fed devices
- Each Pick & Place head can be independently set for various heights
- Ability to rotate components between stations
- Interchangeable sealer/tooling for quick changeover
- Heat or PSA seal capabilities
- Handles tape widths from 8–56 mm
- Standard Empty Pocket Detector sensor



V-TEK , Incorporated
751 Summit Avenue
Mankato, MN 56001
(P) 507 387 2039
(F) 507 387 2257

www.vtekusa.com
www.vtekautomation.com

Specifications:



Controls:

Touch screen Operator Interface includes:

- Run mode/Setup mode
- Device Counter and Batch Size
- Sealer Dwell Adjustment
- Manual/Automatic leader/trailer
- Job capabilities
- Head override for head setup

Dimensions:

- Height: 54" (137 cm)
- Width: 45" (114 cm)
- Depth: 39" (99 cm)

Drive mechanism:

- Servo motor direct drive for turret
 - Motor accuracy: +/- 45ARC-SEC (0.0125 deg)
 - Motor repeatability: +/- 5 ARC-SEC (0.0014 deg)

Power required:

- Electrical: 115/230 VAC, 50-60Hz
- Air: 90 PSI at 6.5 CFM

Placement speed:

- 4000-6000 UPH (device dependent)

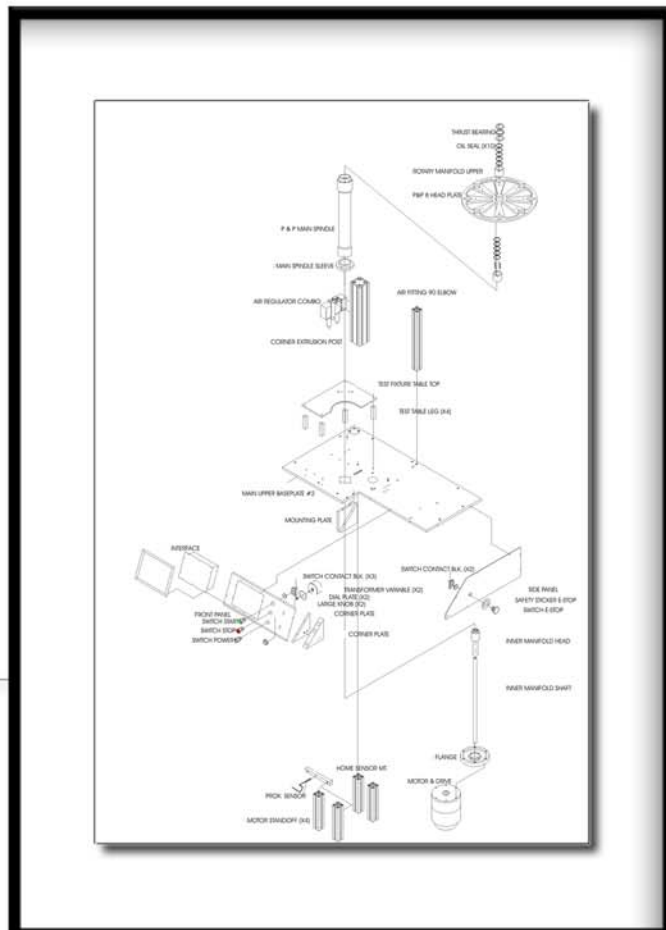

V-TEK , Incorporated
 751 Summit Avenue
 Mankato, MN 56001
 (P) 507 387 2039
 (F) 507 387 2257